

iBVD

Dokument Id
5566815519-00134
Version
1

Skapad
2021-12-29
Publicerad
2021-12-29



Uppgiftslämnaren reserverar sig för eventuella fel i produktinformationen eller felaktigt registrerade uppgifter och förbehåller sig rätten att korrigera och/eller komplettera produktinformation utan föregående avisering

1 GRUNDDATA

Varubeskrivning

plastic device installation trunking systems, partition

Övriga upplysningar

Klassificeringar

ETIM ›	
BK04 ›	
BSAB ›	
UNSPSC ›	

Leverantörsuppgifter

Företagsnamn

OBO Bettermann AB

Organisationsnummer

5566815519

Adress

Hemsida

www.obobettermann.se

Miljökontaktperson

Namn

Matthew Wise

Telefon

+46 73-423 24 75

E-post

wise.matthew@obobettermann.se

2 HÅLLBARHETSARBETE

Företagets certifiering

- ISO 9000
- ISO 14000

INNEHÅLLSDEKLARATION

Kemisk produkt	Nej
Omfattas varan av RoHS-direktivet	Nej
Varans vikt	0,348 kg

Vara / Delkomponenter

Koncentrationen har beräknats på hela varan

Ingående material /komponenter	Vikt-% i komponent	CAS-nr (alt legering)	EG-nr (alt legering)	Vikt % i produkt	Kommentar
Plastic regrind PVC-U RAL7035 (original material 10529969)				100%	

Del av materialinnehållet som är deklarerat 100%

Särskilt farliga ämnen

Varan innehåller INTE några ämnen med särskilt farliga egenskaper (Substances of very high concern, SVHC-ämnen) som finns med på kandidatförteckningen i en koncentration som överstiger 0,1 vikts-%

Utgåva av kandidatförteckningen som har använts

2021-07-08

Nanomaterial

Innehåller produkten tillsatt nanomaterial, som är medvetet tillsatta för att uppnå en viss funktion?: Nej

Tillsatt högflourerade ämnen (PFAS)

Innehåller produkten tillsatt högflourerade ämnen (PFAS), som är aktivt tillsatta för att uppnå en specifik funktion?: Vet ej

Övrigt

Ämnen är redovisade ned till 0,01% viktprocent enligt iBVDs redovisningskrav. Eventuell avvikelser från redovisningskraven redovisas nedan

4

RÅVAROR

Återvunnet material

Innehåller varan återvunnet material: Nej

Träråvara

Träråvara ingår i varan: Nej

5

MILJÖPÅVERKAN

Finns en miljövarudeklaration framtagen enligt EN15804 eller ISO14025 för varan

Nej

Finns annan miljövarudeklaration

Nej

6

DISTRIBUTION

Beskrivning av emballagehantering för distribution av varan

The main packaging is made of paper/cardboard. In addition, PE film or PE bags are sometimes used as protective packaging.

7

BYGGSCKEDET

Ställer varan särskilda krav vid lagring?

Nej

Ställer varan särskilda krav på omgivande byggvaror?

Nej

8

BRUKSSKEDET

Finns skötselansvisningar/skötselråd?

Nej

Finns en energimärkning enligt energimärkningsdirektivet (2010/30/EU) för varan?

Ej relevant

9

RIVNING

Kräver varan särskilda åtgärder för skydd av hälsa och miljö vid rivning/demontering?

Nej

Omfattas den levererade varan av förordningen (2014:1075) om producentansvar för elektriska och elektroniska produkter när den blir avfall?	Nej
Är återanvändning möjlig för hela eller delar av varan?	Nej
Är materialåtervinning möjlig för hela eller delar av varan?	Ja
All components can be recycled	
Är energiåtervinning möjlig för hela eller delar av varan?	Ja
Energy recovery is possible for plastic components	
Har leverantören restriktioner och rekommendationer för återanvändning, material- eller energiåtervinning eller deponering?	Nej
När den levererade varan blir avfall, klassas den då som farligt avfall?	Nej
Avfallskod (EWC) för den levererade varan	170203

E-nummer	Leverantörens artikelnummer	GTIN
11 767 00	6274900	4012195658122

Produktdatablad	Rapid 80 plastic device installation trunking systems.pdf
Prestandadeklaration	
Säkerhetsblad	
Miljövarudeklaration	
Skötselansvisning	
Övriga bifogade dokument	



Rapid 80 plastic device installation trunking systems

	Device installation trunking, 1-compartment, trunking width 110 mm	170
	Device installation trunking, 1-compartment, trunking width 130 mm	174
	Device installation trunking, 1-compartment, trunking width 170 mm	178



Trunking height 70 mm, trunking width 110 mm

Device installation trunking, type GK70110

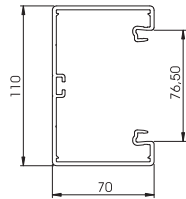

Type	Colour	Length mm	Pack. m	Weight kg/100 m	Item No.
GK-70110RW	Pure white	2000	8	132.000	6274300
GK-70110CW	Cream	2000	8	132.000	6274301
GK-70110LGR	Light grey	2000	8	132.000	6274302
GK-70110GR	Stone grey	2000	8	132.000	6274306

PVC Polyvinylchloride

GK device installation trunking, made of lead-free PVC, suitable for installing directly on the wall or on wall panels. Fastening takes place using the perforation in the trunking. The GK device installation trunking possesses a C profile on the floor to accept a plastic partition. All the switch programmes with a support ring and support clamp design as well as Modul 45 installation devices can be installed in the accessory mounting boxes of series 71GD.... The system opening is 76.5 mm. On each trunking length, a coupling pair is pre-assembled on one side. The cover must be ordered separately.

Coupling

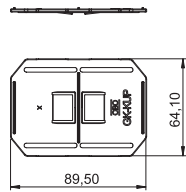

Type	Colour	Pack. PU	Weight kg/100 PUs	Item No.
GK-KUP	Light grey	1	2.140	6274650

ABS/ASA Acrylonitrile butadiene styrene

Coupling as trunking connector for tight connection of the trunking sections. A coupling pair is included and pre-mounted for each stock length.

Accessory mounting box, single

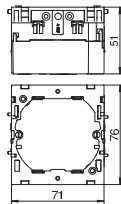

Type	Colour	Pack. pcs	Weight kg/100 pcs.	Item No.
71GD6	Iron grey	5	5.600	6288610

PA Polyamide

Front locking accessory mounting box for switch systems, with folding, and also removable, base for time saving cable connection, with feed openings for cable diameters of up to 14 mm.

Accessory mounting box, double

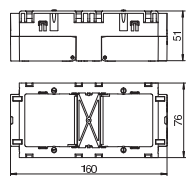

Type	Colour	Pack. pcs	Weight kg/100 pcs.	Item No.
71GD7	Iron grey	2	11.000	6288611

PA Polyamide

Front locking accessory mounting box for standard switch ranges for the installation of two individual installation devices or a multiple power socket. With unfolding, and also removable, base for time-saving cable connection and with feed openings for cable diameters of up to 14 mm.

Strain relief for service outlet

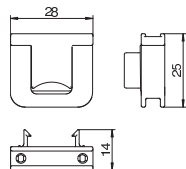

Type	Pack. pcs	Weight kg/100 pcs.	Item No.
7ZE	50	0.700	6288790

PA Polyamide

Strain relief with locking clips, suitable for the accessory mounting boxes 7GD... and 71GD... .

Plastic trunking cover, smooth

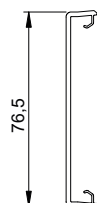

Type	Colour	Length mm	Pack. m	Weight kg/100 m	Item No.
GK-OTGRW	Pure white	2000	16	27.500	6278680
GK-OTGCW	Cream	2000	16	27.500	6278681
GK-OTGLGR	Light grey	2000	16	27.500	6278682
GK-OTGGR	Stone grey	2000	16	27.500	6278686

PVC Polyvinylchloride

Smooth trunking cover, for closing device installation trunking with 76.5 mm system opening.

Plastic trunking cover, fluted

Type	Colour	Length mm	Pack. Weight		Item No.
			m	kg/100 m	
GK-OTKRW	Pure white	2000	16	27.000	6278780
GK-OTKCW	Cream	2000	16	27.000	6278781
GK-OTKLGR	Light grey	2000	16	27.000	6278782

PVC Polyvinylchloride

Fluted trunking cover, for closing device installation trunking with 76.5 mm system opening.

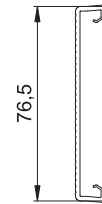

External corner cover, variable

Type	Colour	Length mm	Pack. Weight		Item No.
			pcs	kg/100 pcs.	
GK-AH70110RW	Pure white	130.5	1	15.000	6274210
GK-AH70110CW	Cream	130.5	1	15.000	6274211
GK-AH70110LGR	Light grey	130.5	1	15.000	6274212

PC/ABS Polycarbonate/acrylnitrile-butadiene-styrene

External corner cover made of halogen-free PC/ABS for changing the direction of Rapid 80 device installation trunking of the GK, GKH, GS and GA systems. The fittings can be variably adjusted between 80° and 100° and can be used in symmetrical and asymmetrical trunking.

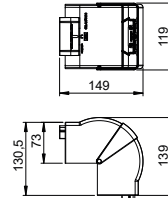

External corner

Type	Colour	Pack. Weight		Item No.
		pcs	kg/100 pcs.	
GK-A70110RW	Pure white	1	116.000	6274310
GK-A70110CW	Cream	1	116.000	6274311
GK-A70110LGR	Light grey	1	116.000	6274312
GK-A70110GR	Stone grey	1	116.000	6274316

PVC Polyvinylchloride

External corner for changing the direction of the GK device installation trunking.

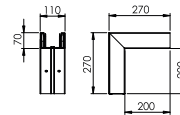

External corner cover, smooth

Type	Colour	Pack. Weight		Item No.
		pcs	kg/100 pcs.	
GK-OTGARW	Pure white	2	9.500	6274790
GK-OTGACW	Cream	2	9.500	6274791
GK-OTGALGR	Light grey	2	9.500	6274792
GK-OTGAGR	Stone grey	2	9.500	6274796

PVC Polyvinylchloride

PVC external corner cover, smooth surface.

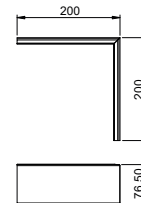

Flat angle cover

Type	Colour	Length mm	Pack. Weight		Item No.
			pcs	kg/100 pcs.	
GK-FH70110RW	Pure white	152.5	1	15.100	6274220
GK-FH70110CW	Cream	152.5	1	15.100	6274221
GK-FH70110LGR	Light grey	152.5	1	15.100	6274222

PC/ABS Polycarbonate/acrylnitrile-butadiene-styrene

Flat angle cover fitting made of halogen-free PC/ABS for simple creation of a rising or falling 90° change of direction with device installation trunking of the series Rapid 80 GK, GKH, GS and GA. The flat angle cover fitting can be used for symmetrical and asymmetrical trunking types.

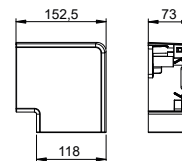

Flat angle

Type	Colour	Pack. Weight		Item No.
		pcs	kg/100 pcs.	
GK-F70110RW	Pure white	1	78.000	6274320
GK-F70110CW	Cream	1	78.000	6274321
GK-F70110LGR	Light grey	1	78.000	6274322
GK-F70110GR	Stone grey	1	78.000	6274326

PVC Polyvinylchloride

Flat angle for changing the direction of the GK device installation trunking.

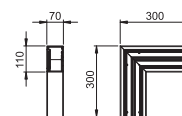

Trunking height 70 mm, trunking width 110 mm

Flat angle cover, smooth

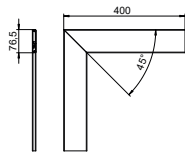

Type	Colour	Pack.	Weight	Item No.
		pcs	kg/100 pcs.	
GK-OTGFRW	Pure white	1	17.000	6274490
GK-OTGFCW	Cream	1	17.000	6274491
GK-OTGFLGR	Light grey	1	17.000	6274492
GK-OTGFGR	Stone grey	1	17.000	6274496

PVC Polyvinylchloride

Flat angle cover, smooth surface.

Internal corner cover, variable

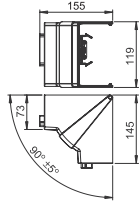

Type	Colour	Pack.	Weight	Item No.
		pcs	kg/100 pcs.	
GK-IH70110RW	Pure white	1	14.200	6274240
GK-IH70110CW	Cream	1	14.200	6274241
GK-IH70110LGR	Light grey	1	14.200	6274282

PC/ABS Polycarbonate/acrylnitrile-butadiene-styrene

Internal corner cover made of halogen-free PC/ABS for changing the direction of Rapid 80 device installation trunking of the GK, GKH GS and GA systems. The fittings can be variably adjusted between 85° and 95° and can be used in symmetrical and asymmetrical trunking.

Internal corner

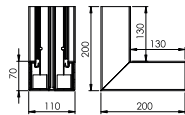

Type	Colour	Pack.	Weight	Item No.
		pcs	kg/100 pcs.	
GK-I70110RW	Pure white	1	100.000	6274340
GK-I70110CW	Cream	1	100.000	6274341
GK-I70110LGR	Light grey	1	100.000	6274342
GK-I70110GR	Stone grey	1	100.000	6274346

PVC Polyvinylchloride

Internal corner for changing the direction of the GK device installation trunking.

T-piece

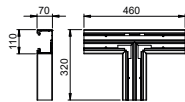

Type	Colour	Pack.	Weight	Item No.
		pcs	kg/100 pcs.	
GK-T70110RW	Pure white	1	100.000	6274360
GK-T70110CW	Cream	1	100.000	6274361
GK-T70110LGR	Light grey	1	100.000	6274362
GK-T70110GR	Stone grey	1	100.000	6274366

PVC Polyvinylchloride

T-piece for changing the direction of the GK device installation trunking.

End piece

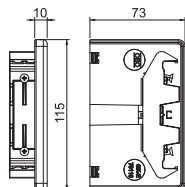

Type	Colour	Pack.	Weight	Item No.
		pcs	kg/100 pcs.	
GK-E70110RW	Pure white	1	5.009	6274370
GK-E70110CW	Cream	1	5.009	6274371
GK-E70110LGR	Light grey	1	5.009	6274372
GK-E70110GR	Stone grey	1	5.009	6274376

PVC Polyvinylchloride

End piece for closing the GK device installation trunking.

Partition

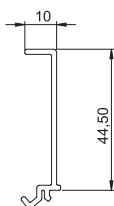

Type	Length mm	Pack.	Weight	Item No.
		m	kg/100 m	
GK-TW70	2000	40	17.400	6274900

PVC Polyvinylchloride

Partition for mounting in Rapid 80 GK, GA and Rapid IBIS device installation trunking or ISS service poles for installing cables of different voltage levels.

Duct clamp

Type	Surface	Length	Colour	Pack.	Weight	Item No.
	finish	mm		pcs	kg/100 pcs.	
KL80A	—	—	Light grey	20	0.685	6288640

PC/ABS Polycarbonate/acrylnitrile-butadiene-styrene

Duct clamp for holding cables securely and for fastening the partition in Rapid 80 GK, GS and GA device installation trunking systems as well as in ISS service poles with a 76.5 mm system opening.



Trunking height 70 mm, trunking width 130 mm

Device installation trunking, type GK70130

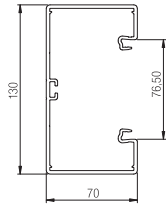

Type	Colour	Length mm	Pack. m	Weight kg/100 m	Item No.
GK-70130RW	Pure white	2000	8	152.000	6274500
GK-70130CW	Cream	2000	8	152.000	6274501
GK-70130LGR	Light grey	2000	8	152.000	6274502
GK-70130GR	Stone grey	2000	8	152.000	6274506

PVC Polyvinylchloride

GK device installation trunking, made of lead-free PVC, suitable for installing directly on the wall or on wall panels. Fastening takes place using the perforation in the trunking. The GK device installation trunking possesses a C profile on the floor to accept a plastic partition. All the switch programmes with a support ring and support clamp design as well as Modul 45 installation devices can be installed in the accessory mounting boxes of series 71GD.... The system opening is 76.5 mm. On each trunking length, a coupling pair is pre-assembled on one side. The cover must be ordered separately.

Coupling

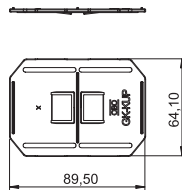

Type	Colour	Pack. PU	Weight kg/100 PUs	Item No.
GK-KUP	Light grey	1	2.140	6274650

ABS/ASA Acrylonitrile butadiene styrene

Coupling as trunking connector for tight connection of the trunking sections. A coupling pair is included and pre-mounted for each stock length.

Accessory mounting box, single

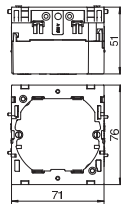

Type	Colour	Pack. pcs	Weight kg/100 pcs.	Item No.
71GD6	Iron grey	5	5.600	6288610

PA Polyamide

Front locking accessory mounting box for switch systems, with folding, and also removable, base for time saving cable connection, with feed openings for cable diameters of up to 14 mm.

Accessory mounting box, double

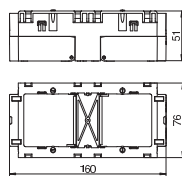

Type	Colour	Pack. pcs	Weight kg/100 pcs.	Item No.
71GD7	Iron grey	2	11.000	6288611

PA Polyamide

Front locking accessory mounting box for standard switch ranges for the installation of two individual installation devices or a multiple power socket. With unfolding, and also removable, base for time-saving cable connection and with feed openings for cable diameters of up to 14 mm.

Accessory mounting box, British Standard, single

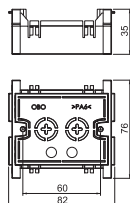

Type	Colour	Pack. pcs	Weight kg/100 pcs.	Item No.
71GDBS1	—	10	3.300	6288585

PA Polyamide

Front-locking, single accessory mounting box for British Standard switch systems. Insertion opening for cable diameters of up to max. 17 mm. Can be used in all device installation trunking of the Rapid 80 series and ISS service poles with 76.5 mm system opening.

Accessory mounting box, British Standard, double

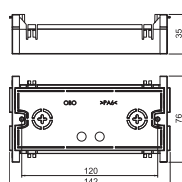

Type	Colour	Pack. pcs	Weight kg/100 pcs.	Item No.
71GDBS2	—	10	5.300	6288586

PA Polyamide

Front-locking, double accessory mounting box for British Standard switch systems. Insertion opening for cable diameters of up to max. 17 mm. Can be used in all device installation trunking of the Rapid 80 series and ISS service poles with 76.5 mm system opening.

Strain relief for service outlet

Type	Colour	Length mm	Pack. pcs	Weight kg/100 pcs	Item No.
7ZE			50	0.700	6288790

PA Polyamide

Strain relief with locking clips, suitable for the accessory mounting boxes 7GD... and 71GD...

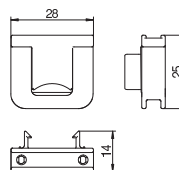

Plastic trunking cover, smooth

Type	Colour	Length mm	Pack. m	Weight kg/100 m	Item No.
GK-OTGRW	Pure white	2000	16	27.500	6278680
GK-OTGCW	Cream	2000	16	27.500	6278681
GK-OTGLGR	Light grey	2000	16	27.500	6278682
GK-OTGGR	Stone grey	2000	16	27.500	6278686

PVC Polyvinylchloride

Smooth trunking cover, for closing device installation trunking with 76.5 mm system opening.

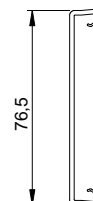

Plastic trunking cover, fluted

Type	Colour	Length mm	Pack. m	Weight kg/100 m	Item No.
GK-OTKRW	Pure white	2000	16	27.000	6278780
GK-OTKCW	Cream	2000	16	27.000	6278781
GK-OTKLGR	Light grey	2000	16	27.000	6278782

PVC Polyvinylchloride

Fluted trunking cover, for closing device installation trunking with 76.5 mm system opening.

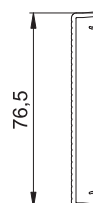

External corner cover, variable

Type	Colour	Length mm	Pack. pcs	Weight kg/100 pcs	Item No.
GK-AH70130RW	Pure white	130.5	1	18.535	6274410
GK-AH70130CW	Cream	130.5	1	16.100	6274411
GK-AH70130LGR	Light grey	130.5	1	16.100	6274412

PC/ABS Polycarbonate/acrylnitrile-butadiene-styrene

External corner cover made of halogen-free PC/ABS for changing the direction of Rapid 80 device installation trunking of the GK, GKH, GS and GA systems. The fittings can be variably adjusted between 80° and 100° and can be used in symmetrical and asymmetrical trunking.

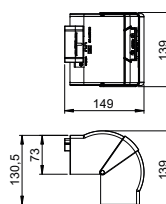

External corner

Type	Colour	Pack. pcs	Weight kg/100 pcs	Item No.
GK-A70130RW	Pure white	1	127.000	6274510
GK-A70130CW	Cream	1	127.000	6274511
GK-A70130LGR	Light grey	1	127.000	6274512
GK-A70130GR	Stone grey	1	127.000	6274516

PVC Polyvinylchloride

External corner for changing the direction of the GK device installation trunking.

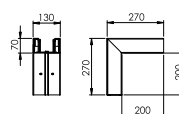

External corner cover, smooth

Type	Colour	Pack. pcs	Weight kg/100 pcs	Item No.
GK-OTGARW	Pure white	2	9.500	6274790
GK-OTGACW	Cream	2	9.500	6274791
GK-OTGALGR	Light grey	2	9.500	6274792
GK-OTGAGR	Stone grey	2	9.500	6274796

PVC Polyvinylchloride

PVC external corner cover, smooth surface.

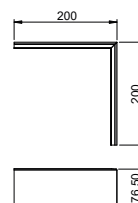

Trunking height 70 mm, trunking width 130 mm

Flat angle cover

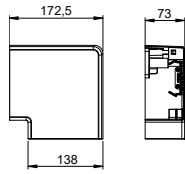

Type	Colour	Length mm	Pack. pcs	Weight kg/100 pcs.	Item No.
GK-FH70130RW	Pure white	172.5	1	17.100	6274420
GK-FH70130CW	Cream	172.5	1	17.100	6274421
GK-FH70130LGR	Light grey	172.5	1	17.100	6274422

PC/ABS Polycarbonate/acrylnitrile-butadiene-styrene

Flat angle cover fitting made of halogen-free PC/ABS for simple creation of a rising or falling 90° change of direction with device installation trunking of the series Rapid 80 GK, GKH, GS and GA. The flat angle cover fitting can be used for symmetrical and asymmetrical trunking types.

Flat angle

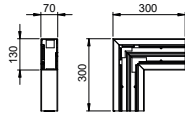

Type	Colour	Pack. pcs	Weight kg/100 pcs.	Item No.
GK-F70130RW	Pure white	1	83.000	6274520
GK-F70130CW	Cream	1	83.000	6274521
GK-F70130LGR	Light grey	1	83.000	6274522
GK-F70130GR	Stone grey	1	83.000	6274526

PVC Polyvinylchloride

Flat angle for changing the direction of the GK device installation trunking.

Flat angle cover, smooth

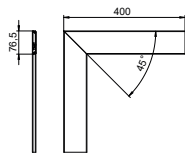

Type	Colour	Pack. pcs	Weight kg/100 pcs.	Item No.
GK-OTGFRW	Pure white	1	17.000	6274490
GK-OTGFCW	Cream	1	17.000	6274491
GK-OTGFLGR	Light grey	1	17.000	6274492
GK-OTGFGR	Stone grey	1	17.000	6274496

PVC Polyvinylchloride

Flat angle cover, smooth surface.

Internal corner cover, variable

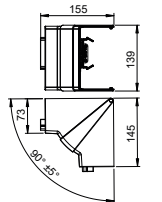

Type	Colour	Pack. pcs	Weight kg/100 pcs.	Item No.
GK-IH70130RW	Pure white	1	14.900	6274440
GK-IH70130CW	Cream	1	14.900	6274441
GK-IH70130LGR	Light grey	1	14.900	6274442

PC/ABS Polycarbonate/acrylnitrile-butadiene-styrene

Internal corner cover made of halogen-free PC/ABS for changing the direction of Rapid 80 device installation trunking of the GK, GKH GS and GA systems. The fittings can be variably adjusted between 85° and 95° and can be used in symmetrical and asymmetrical trunking.

Internal corner

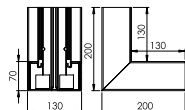

Type	Colour	Pack. pcs	Weight kg/100 pcs.	Item No.
GK-I70130RW	Pure white	1	110.000	6274540
GK-I70130CW	Cream	1	110.000	6274541
GK-I70130LGR	Light grey	1	110.000	6274542
GK-I70130GR	Stone grey	1	110.000	6274546

PVC Polyvinylchloride

Internal corner for changing the direction of the GK device installation trunking.

T-piece

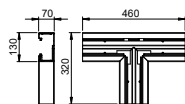

Type	Colour	Pack. pcs	Weight kg/100 pcs.	Item No.
GK-T70130RW	Pure white	1	108.000	6274560
GK-T70130CW	Cream	1	108.000	6274561
GK-T70130LGR	Light grey	1	108.000	6274562
GK-T70130GR	Stone grey	1	108.000	6274566

PVC Polyvinylchloride

T-piece for changing the direction of the GK device installation trunking.

Type	Surface finish	Length mm	Colour	Pack. pcs	Weight		Item No.
					kg/100 pcs.		
GK-E70130RW	—	—	Pure white	1	5.574		6274570
GK-E70130CW	—	—	Cream	1	5.621		6274571
GK-E70130LGR	—	—	Light grey	1	5.621		6274572
GK-E70130GR	—	—	Stone grey	1	5.621		6274576

PVC Polyvinylchloride

End piece for closing the GK device installation trunking.

End piece

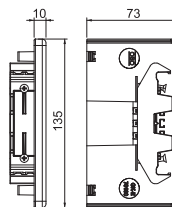

Type	Length mm	Pack. m	Weight		Item No.
			kg/100 m		
GK-TW70	2000	40	17.400		6274900

PVC Polyvinylchloride

Partition for mounting in Rapid 80 GK, GA and Rapid IBIS device installation trunking or ISS service poles for installing cables of different voltage levels.

Partition

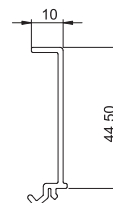

Type	Surface finish	Length mm	Colour	Pack. pcs	Weight		Item No.
					kg/100 pcs.		
KL80A	—	—	Light grey	20	0.685		6288640

PC/ABS Polycarbonate/acrylnitrile-butadiene-styrene

Duct clamp for holding cables securely and for fastening the partition in Rapid 80 GK, GS and GA device installation trunking systems as well as in ISS service poles with a 76.5 mm system opening.

Duct clamp



Trunking height 70 mm, trunking width 170 mm

Device installation trunking, type GK70170

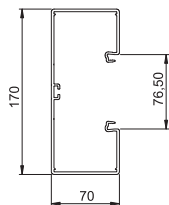

Type	Colour	Length mm	Pack. m	Weight kg/100 m	Item No.
GK-70170RW	Pure white	2000	8	180.000	6274700
GK-70170CW	Cream	2000	8	180.000	6274701
GK-70170LGR	Light grey	2000	8	180.000	6274702
GK-70170GR	Stone grey	2000	8	180.000	6274706

PVC Polyvinylchloride

GK device installation trunking, made of lead-free PVC, suitable for installing directly on the wall or on wall panels. Fastening takes place using the perforation in the trunking. The GK device installation trunking possesses a C profile on the floor to accept a plastic partition. All the switch programmes with a support ring and support clamp design as well as Modul 45 installation devices can be installed in the accessory mounting boxes of series 71GD.... The system opening is 76.5 mm. On each trunking length, a coupling pair is pre-assembled on one side. The cover must be ordered separately.

Coupling

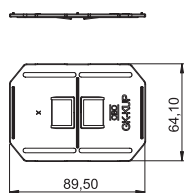

Type	Colour	Pack. PU	Weight kg/100 PUs	Item No.
GK-KUP	Light grey	1	2.140	6274650

ABS/ASA Acrylonitrile butadiene styrene

Coupling as trunking connector for tight connection of the trunking sections. A coupling pair is included and pre-mounted for each stock length.

Accessory mounting box, single

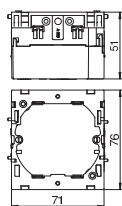

Type	Colour	Pack. pcs	Weight kg/100 pcs.	Item No.
71GD6	Iron grey	5	5.600	6288610

PA Polyamide

Front locking accessory mounting box for switch systems, with folding, and also removable, base for time saving cable connection, with feed openings for cable diameters of up to 14 mm.

Accessory mounting box, double

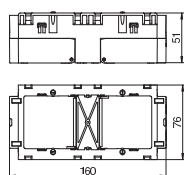

Type	Colour	Pack. pcs	Weight kg/100 pcs.	Item No.
71GD7	Iron grey	2	11.000	6288611

PA Polyamide

Front locking accessory mounting box for standard switch ranges for the installation of two individual installation devices or a multiple power socket. With unfolding, and also removable, base for time-saving cable connection and with feed openings for cable diameters of up to 14 mm.

Strain relief for service outlet

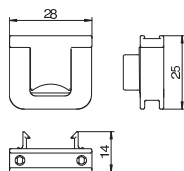

Type	Pack. pcs	Weight kg/100 pcs.	Item No.
7ZE	50	0.700	6288790

PA Polyamide

Strain relief with locking clips, suitable for the accessory mounting boxes 7GD... and 71GD... .

Plastic trunking cover, smooth

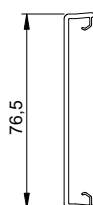

Type	Colour	Length mm	Pack. m	Weight kg/100 m	Item No.
GK-OTGRW	Pure white	2000	16	27.500	6278680
GK-OTGCW	Cream	2000	16	27.500	6278681
GK-OTGLGR	Light grey	2000	16	27.500	6278682
GK-OTGGR	Stone grey	2000	16	27.500	6278686

PVC Polyvinylchloride

Smooth trunking cover, for closing device installation trunking with 76.5 mm system opening.

Plastic trunking cover, fluted

Type	Colour	Length mm	Pack. m	Weight		Item No.
				kg/100 m		
GK-OTKRW	Pure white	2000	16	27.000		6278780
GK-OTKCW	Cream	2000	16	27.000		6278781
GK-OTKLGR	Light grey	2000	16	27.000		6278782

PVC Polyvinylchloride

Fluted trunking cover, for closing device installation trunking with 76.5 mm system opening.

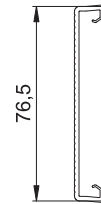

External corner cover, variable

Type	Colour	Length mm	Pack. pcs	Weight		Item No.
				kg/100 pcs		
GK-AH70170RW	Pure white	130.5	1	20.490		6274610
GK-AH70170CW	Cream	130.5	1	20.490		6274611
GK-AH70170LGR	Light grey	130.5	1	20.490		6274612

PC/ABS Polycarbonate/acrylnitrile-butadiene-styrene

External corner cover made of halogen-free PC/ABS for changing the direction of Rapid 80 device installation trunking of the GK, GKH, GS and GA systems. The fittings can be variably adjusted between 80° and 100° and can be used in symmetrical and asymmetrical trunking.

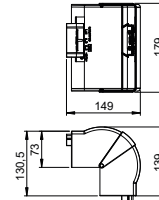

External corner

Type	Colour	Pack. pcs	Weight		Item No.
			kg/100 pcs		
GK-A70170RW	Pure white	1	149.000		6274710
GK-A70170CW	Cream	1	149.000		6274711
GK-A70170LGR	Light grey	1	149.000		6274712
GK-A70170GR	Stone grey	1	149.000		6274716

PVC Polyvinylchloride

External corner for changing the direction of the GK device installation trunking.

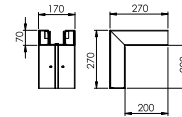

External corner cover, smooth

Type	Colour	Pack. pcs	Weight		Item No.
			kg/100 pcs		
GK-OTGARW	Pure white	2	9.500		6274790
GK-OTGACW	Cream	2	9.500		6274791
GK-OTGALGR	Light grey	2	9.500		6274792
GK-OTGAGR	Stone grey	2	9.500		6274796

PVC Polyvinylchloride

PVC external corner cover, smooth surface.

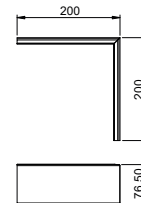

Flat angle cover

Type	Colour	Length mm	Pack. pcs	Weight		Item No.
				kg/100 pcs		
GK-FH70170RW	Pure white	212.5	1	19.131		6274620
GK-FH70170CW	Cream	212.5	1	19.131		6274621
GK-FH70170LGR	Light grey	212.5	1	19.131		6274622

PC/ABS Polycarbonate/acrylnitrile-butadiene-styrene

Flat angle cover fitting made of halogen-free PC/ABS for simple creation of a rising or falling 90° change of direction with device installation trunking of the series Rapid 80 GK, GKH, GS and GA. The flat angle cover fitting can be used for symmetrical and asymmetrical trunking types.

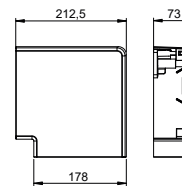

Flat angle

Type	Colour	Pack. pcs	Weight		Item No.
			kg/100 pcs		
GK-F70170RW	Pure white	1	91.000		6274720
GK-F70170CW	Cream	1	91.000		6274721
GK-F70170LGR	Light grey	1	91.000		6274722
GK-F70170GR	Stone grey	1	91.000		6274726

PVC Polyvinylchloride

Flat angle for changing the direction of the GK device installation trunking.

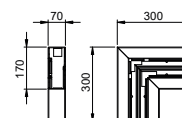

Trunking height 70 mm, trunking width 170 mm

Flat angle cover, smooth

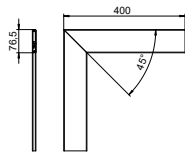

Type	Colour	Pack.	Weight	Item No.
		pcs	kg/100 pcs.	
GK-OTGFRW	Pure white	1	17.000	6274490
GK-OTGFCW	Cream	1	17.000	6274491
GK-OTGFLGR	Light grey	1	17.000	6274492
GK-OTGFGR	Stone grey	1	17.000	6274496

PVC Polyvinylchloride

Flat angle cover, smooth surface.

Internal corner cover, trunking height 70 mm

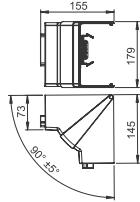

Type	Colour	Pack.	Weight	Item No.
		pcs	kg/100 pcs.	
GK-IH70170RW	Pure white	1	16.300	6274640
GK-IH70170CW	Cream	1	16.300	6274641
GK-IH70170LGR	Light grey	1	16.300	6274642

PC/ABS Polycarbonate/acrylnitrile-butadiene-styrene

Internal corner cover made of halogen-free PC/ABS for changing the direction of Rapid 80 device installation trunking of the GK, GKH GS and GA systems. The fittings can be variably adjusted between 85° and 95° and can be used in symmetrical and asymmetrical trunking.

Internal corner

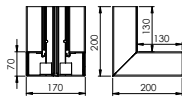

Type	Colour	Pack.	Weight	Item No.
		pcs	kg/100 pcs.	
GK-I70170RW	Pure white	1	130.000	6274740
GK-I70170CW	Cream	1	130.000	6274741
GK-I70170LGR	Light grey	1	130.000	6274742
GK-I70170GR	Stone grey	1	130.000	6274746

PVC Polyvinylchloride

Internal corner for changing the direction of the GK device installation trunking.

T-piece

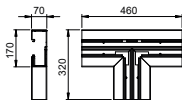

Type	Colour	Pack.	Weight	Item No.
		pcs	kg/100 pcs.	
GK-T70170RW	Pure white	1	120.000	6274760
GK-T70170CW	Cream	1	120.000	6274761
GK-T70170LGR	Light grey	1	120.000	6274762
GK-T70170GR	Stone grey	1	120.000	6274766

PVC Polyvinylchloride

T-piece for changing the direction of the GK device installation trunking.

End piece

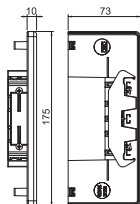

Type	Colour	Pack.	Weight	Item No.
		pcs	kg/100 pcs.	
GK-E70170RW	Pure white	1	6.840	6274770
GK-E70170CW	Cream	1	6.840	6274771
GK-E70170LGR	Light grey	1	6.840	6274772
GK-E70170GR	Stone grey	1	6.840	6274776

PVC Polyvinylchloride

End piece for closing the GK device installation trunking.

Partition

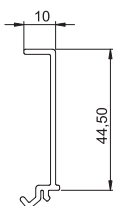

Type	Length mm	Pack.	Weight	Item No.
		m	kg/100 m	
GK-TW70	2000	40	17.400	6274900

PVC Polyvinylchloride

Partition for mounting in Rapid 80 GK, GA and Rapid IBIS device installation trunking or ISS service poles for installing cables of different voltage levels.

Duct clamp

Type	Surface	Length	Colour	Pack.	Weight	Item No.
	finish	mm		pcs	kg/100 pcs.	
KL80A	—	—	Light grey	20	0.685	6288640

PC/ABS Polycarbonate/acrylnitrile-butadiene-styrene

Duct clamp for holding cables securely and for fastening the partition in Rapid 80 GK, GS and GA device installation trunking systems as well as in ISS service poles with a 76.5 mm system opening.

